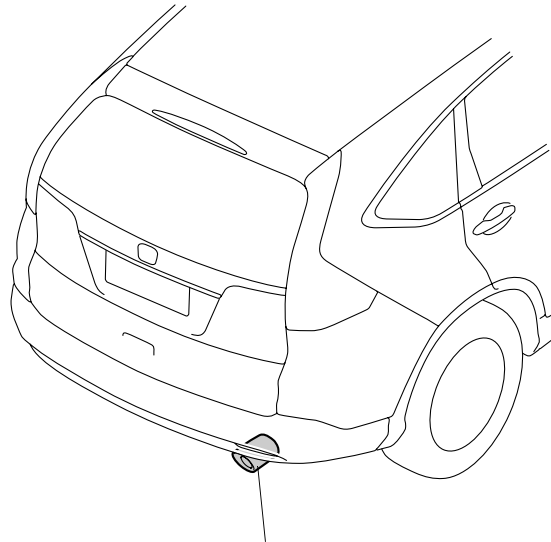

EXHAUST PIPE FINISHER**CR-V****GENERAL VIEW****EXHAUST PIPE FINISHER**

QA62908AB

FOR YOUR SAFETY (Read carefully)**Introduction of Symbol Messages**

- These symbols warn you about the possible hazards and explain how to avoid them. And give you some advices.

⚠ DANGER

You will be killed or seriously hurt if you do not follow the instructions.

⚠ WARNING

You can be killed or seriously hurt if you do not follow the instructions.

⚠ CAUTION

You can be hurt if you do not follow the instructions.

NOTICEGives advice to prevent damage to the product.
Gives helpful information or instructions to be followed in using the product.

Indicates prohibited actions.

Introduction of Icons

- These icons indicate the working place and the worker's vision.

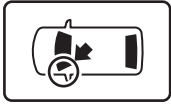

The place for the vehicle.

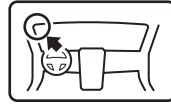

The place for the instrument panel.

- These icons indicate the necessary things for your safety and the work.



Wear eye protection.



Wear heavy gloves.



Work with an assistant.



Place the part on a blanket.



Remove any burrs.



Use the touch-up paint and dry.



Keep the parts and give it to the customer.
(Not use)



Press firmly.



Tighten by specified torque.



Work perpendicularly.



Clean with the contact cleaner.

Safety: General

- Observe all safety notes and precautions described in the Shop Manual in addition to those described in this Installation Instruction. Be extremely careful for your safety and safety of others particularly.
- Be careful not to damage the vehicle and the parts.

Safety: For the Accessory

- This accessory is designed to be used exclusively on this model. It cannot be installed on the other models.
- Note that the exhaust pipe is very hot right after stopping the engine. Install the accessory when the exhaust pipe has been cooled down enough.
- Always use the parts and tools specified in the installation instructions.

PARTS LIST

Exhaust Pipe Finisher Kit

Exhaust pipe finisher	Washer-bolt

TOOLS AND SUPPLIES REQUIRED

- Ratchet
- 10 mm Socket
- Torque wrench

INSTALLATION

Installing the Exhaust Pipe Finisher

1. Loosely install the exhaust pipe finisher.

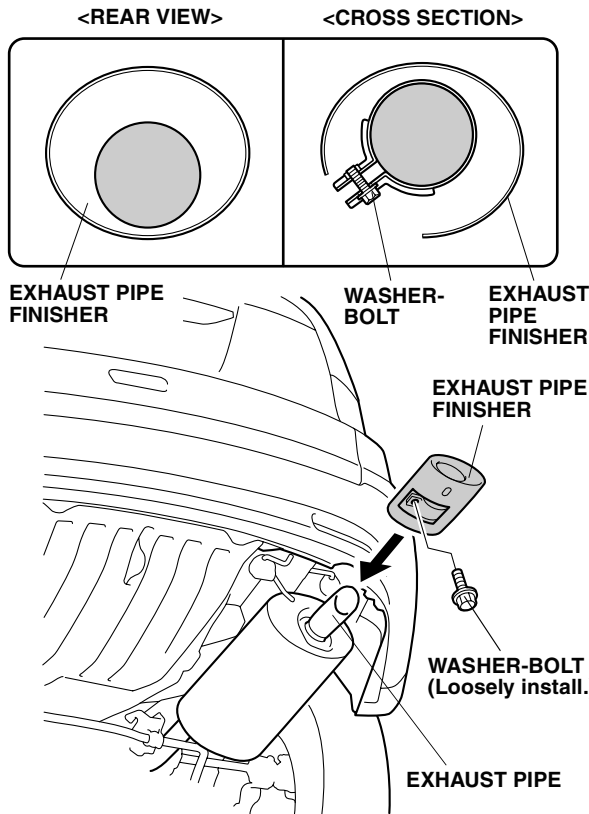
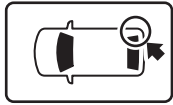

QA11102BD

2. Secure the exhaust pipe finisher.

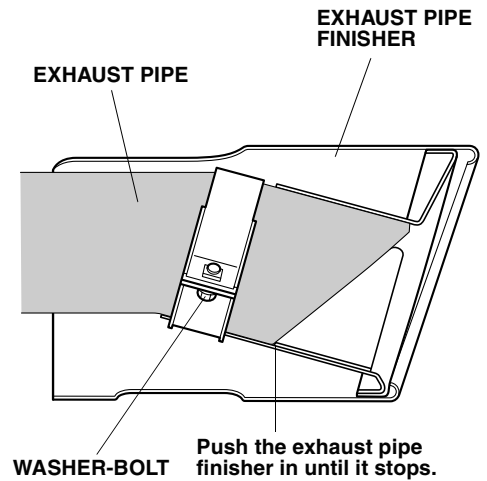

QA11103AD

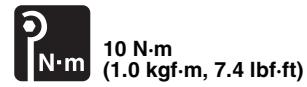

Check After Installation

3. Check that all parts are installed properly.

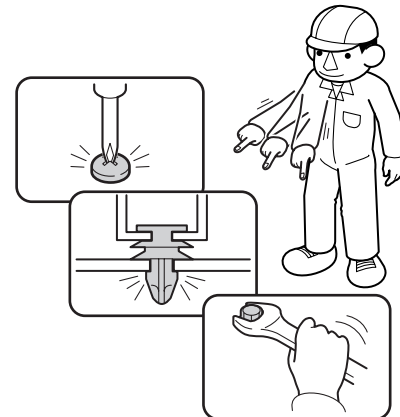

Q060705AM

4. After installing the exhaust pipe finisher, start the engine and check for loose installation and abnormal noise.

Please give your customer a copy of this page.

Use and Care

- Wax the exhaust pipe finisher using a non-abrasive wax. Never use a wax that contains abrasive material as it may scratch the surface.