

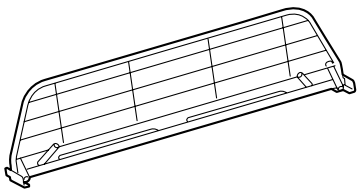

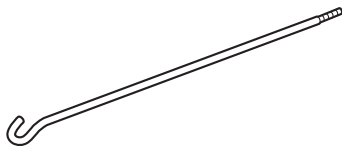

Parts List

Dog guard	Dog guard hook	(2)	Hook	(2)
				
Knob	Nut	(4)	Spacer	(2)
				
Collar		(4)		
				

Tool and Supplies Required

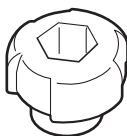
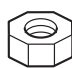
- Electric drill motor
- Drill bit (3 mm, 10 mm)
- File

Before You Begin

Customer Information

- Be careful not to damage the body.

# Installation

1. Open the tailgate.
2. When the vehicle is equipped with the tonneau cover, release the two hooks, and remove the tonneau cover. Turn the rear seat back to the front side.
  - Store the tonneau cover after removing it.

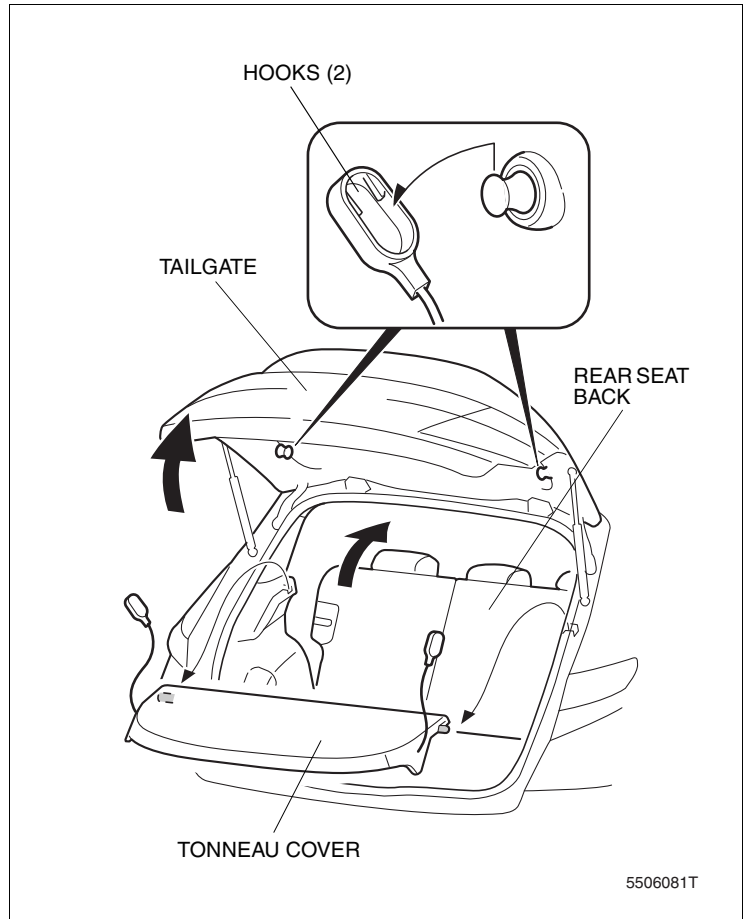

3. Measure the rear side garnish and mark it with a felt-tip pen.
4. Drill the rear side garnish through the mark you just made using an electric drill motor (with 3 mm bit first, then finish drilling with 10 mm drill bit).
5. Repeat the procedure on the other side.
  - Remove the burrs thoroughly from the edge of the holes.

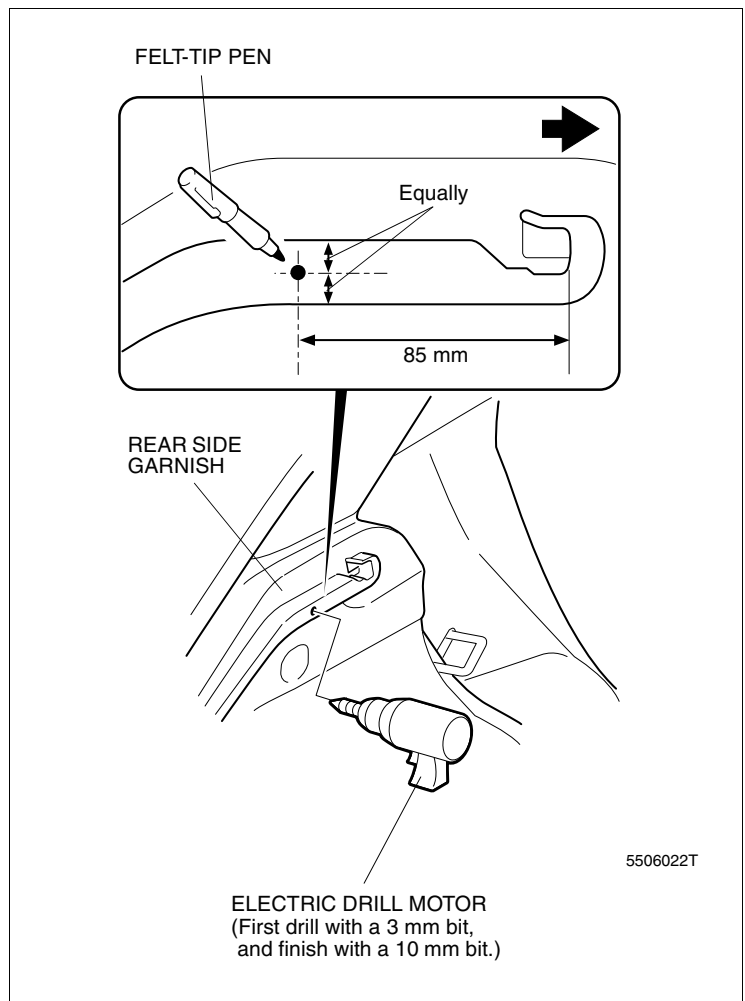

6. Install the spacer in the hole you made in the rear side garnish.
7. Repeat the procedure on the other side.

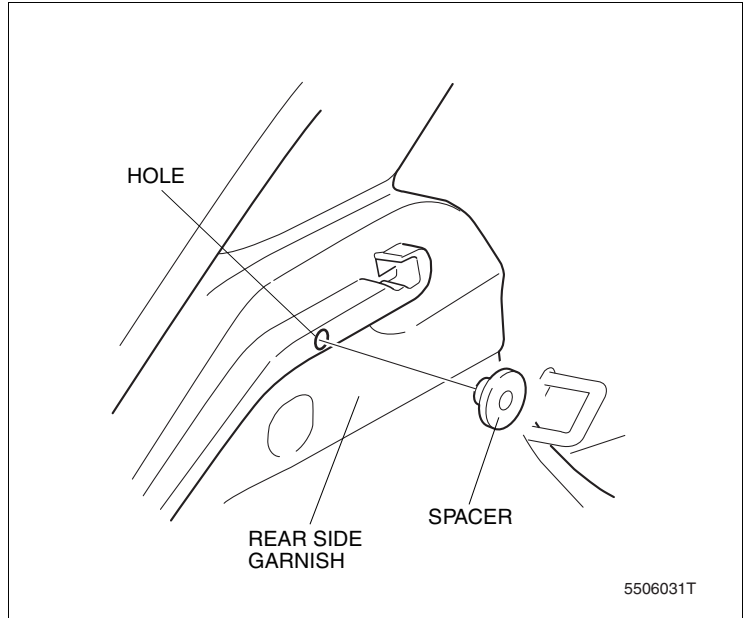

8. Insert the hook into the spacer mounted on the rear side garnish and turn the hook so its end points rearward of the car.
9. Repeat the procedure on the other side.

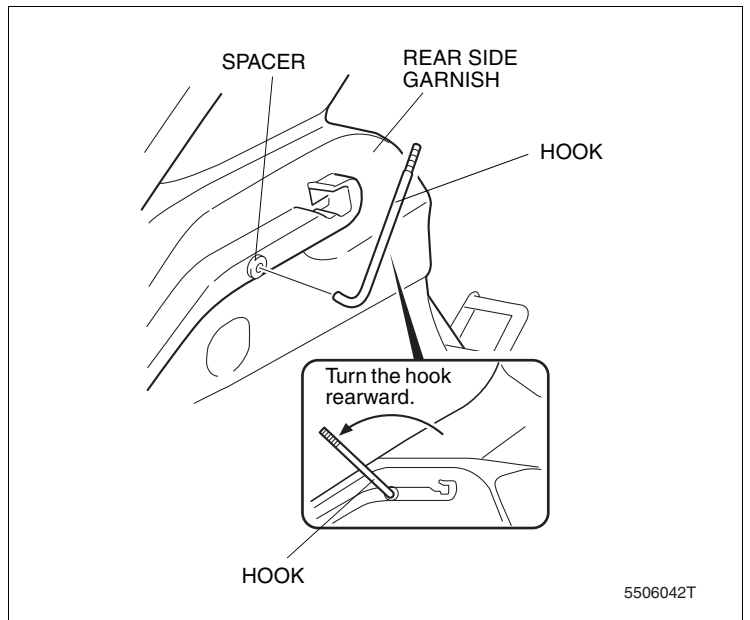

10. Hook the dog guard on the hook that you just installed on the rear side garnish (right and left sides).
11. Raise the dog guard you just hooked on the hook by turning it forward and position it on the rear side garnish.

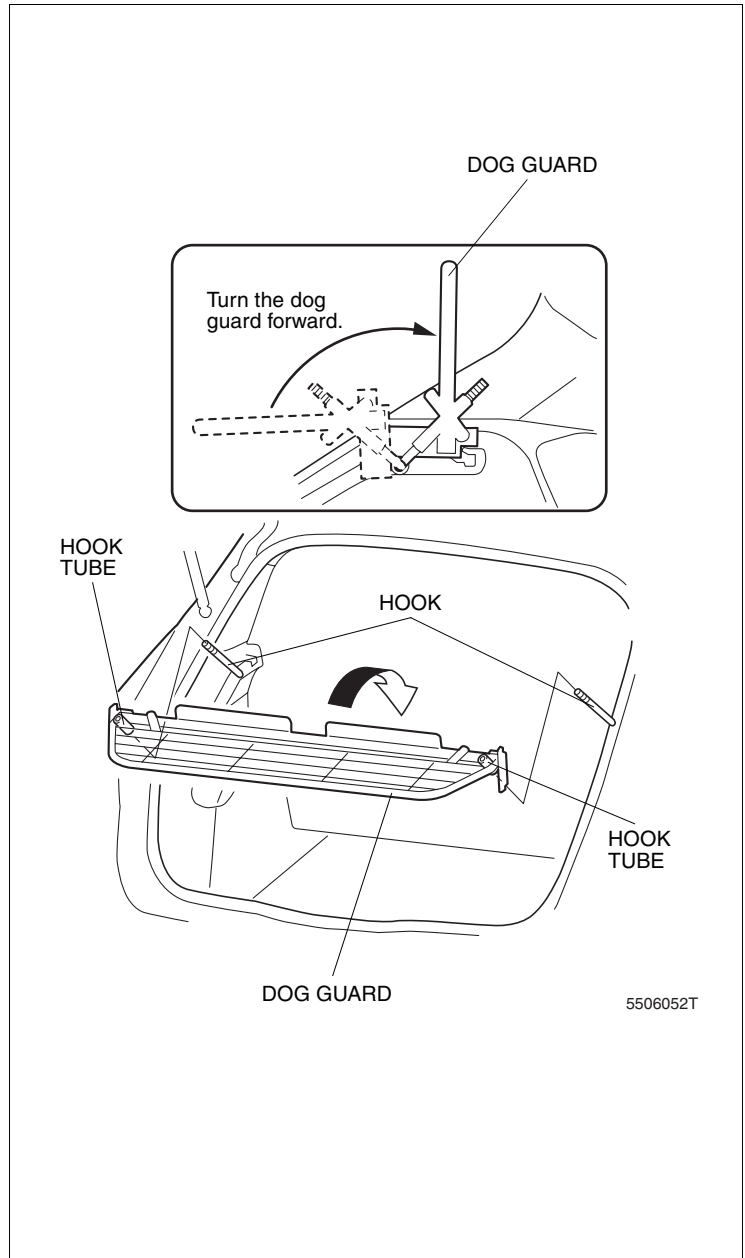

12. Install the collar on the end of the hook, that is out of the hook tube, and loosely tighten the knob on the hook.
  - Insert a nut into the knob before tightening it.
13. Repeat the procedure on the other side.

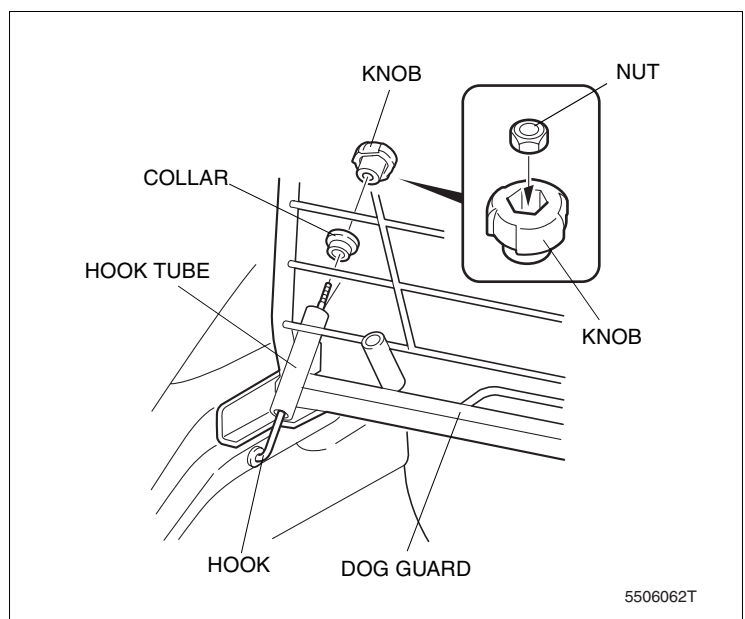

14. Insert the dog guard hook into the tube of the dog guard. Hook the dog guard hook on the vehicle's striker from the bottom.
  - Note the direction of the dog guard hook that is hooked on the vehicle's striker.
15. Install the collar on the end of the dog guard hook, that is out of the tube, and loosely tighten the knob on the hook.
  - Insert a nut into the knob before tightening it.
16. Repeat the procedure on the other side.

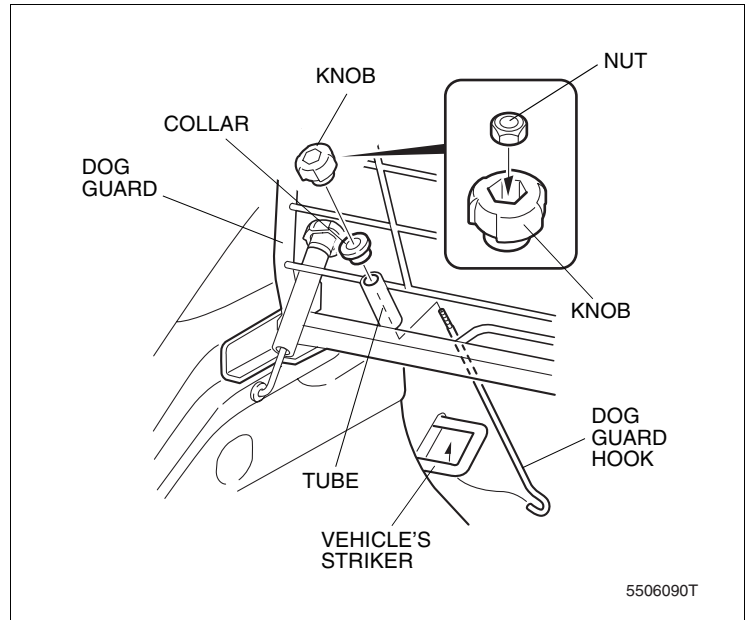

17. Tighten the knob equally on the right and left sides of the car.
  - Do not tighten them excessively.

