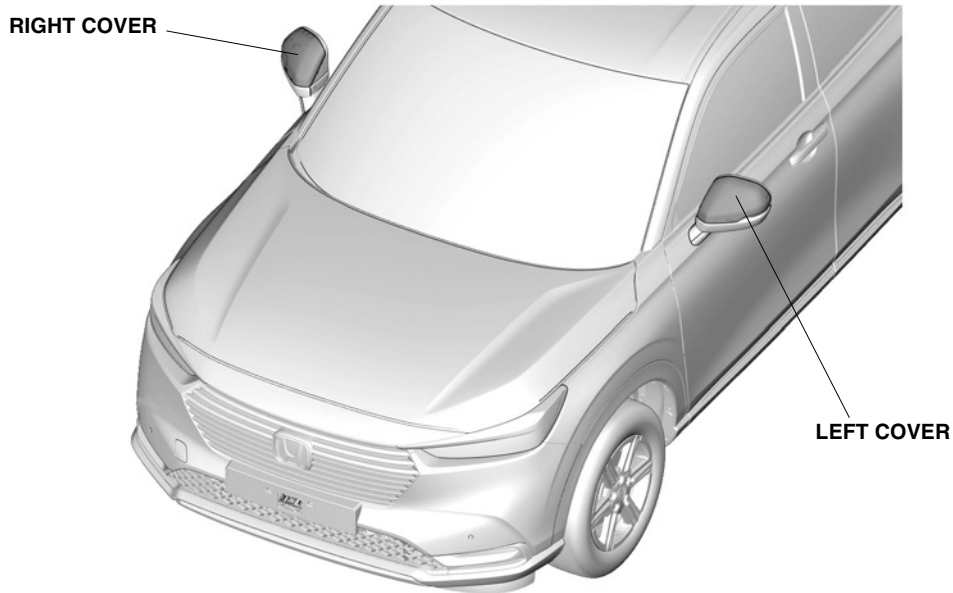

**DOOR MIRROR COVERS*****HR-V*****GENERAL VIEW**

QL60601BH

**FOR YOUR SAFETY (Read carefully)****Introduction of Symbol Messages**

- These symbols warn you about the possible hazards and explain how to avoid them. And give you some advices.

**⚠ DANGER**

You will be killed or seriously hurt if you do not follow the instructions.

**⚠ WARNING**

You can be killed or seriously hurt if you do not follow the instructions.

**⚠ CAUTION**

You can be hurt if you do not follow the instructions.

**NOTICE**Gives advice to prevent damage to the product.  
Gives helpful information or instructions to be followed in using the product.

Indicates prohibited actions.

## Introduction of Icons

- These icons indicate the working place and the worker's vision.

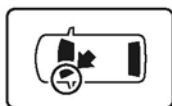

The place for the vehicle.

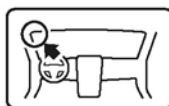

The place for the instrument panel.

- These icons indicate the necessary things for your safety and the work.



Wear eye protection.



Wear heavy gloves.



Work with an assistant.



Place the part on a blanket.



Remove any burrs.



Use the touch-up paint and dry.



Keep the parts and give it to the customer.  
(Not use)



Press firmly.



Tighten by specified torque.



Work perpendicularly.



Clean with the contact cleaner.

## Wire Harness Routing Precaution

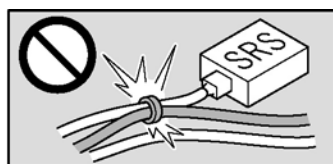

Do not clamp the accessory harness and SRS harness together. (except for instruction cases).



Connect the connectors and terminals securely until they lock.

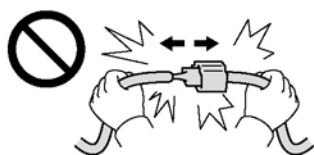

Do not pull the harness to disconnect the connectors.



Reinstall the connectors to the original positions if they are removed.

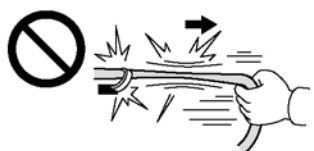

Do not pull the harness strongly.



Secure the accessory harness to the specified position, not to hang down.



Do not pinch the harness with the parts.

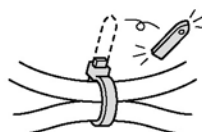

Cut off the excess of the wire ties.

## Safety: General

- Observe all safety notes and precautions described in the Shop Manual in addition to those described in this Installation Instructions. Be extremely careful for your safety and safety of others particularly.
- Be careful not to damage the vehicle and the parts.
- Be extremely careful to the handling of the retaining tabs and clips particularly.
- Note the locations of the parts before removing them so that they can be reinstalled in their original positions properly.
- The illustrations may differ a little from the actual accessories for the design change of the vehicle.

## Safety: For Electric Parts

- Do not perform the installation of the accessories with having connected negative cable of the battery.

## PARTS LIST

### Door Mirror Cover Kit



## TOOLS AND SUPPLIES REQUIRED

- |                         |          |              |
|-------------------------|----------|--------------|
| • Flat-tip screwdriver  | • Tape   | • Shop towel |
| • 10 mm Open end wrench | • Grease | • Ratchet    |
| • 10 mm Socket          |          |              |

# INSTALLATION

## Disconnecting the Battery Cable

1. Perform the works before disconnecting the negative cable from the battery as shown below.
2. Make sure if you have the anti-theft code for the audio/navigation system. Record some settings of the vehicle if necessary.
3. Disconnect the negative cable from the battery.

### NOTICE

- With the driver's door open, turn the vehicle to the OFF (LOCK) mode, then wait at least 3 minutes before disconnecting the 12 volt negative battery cable.

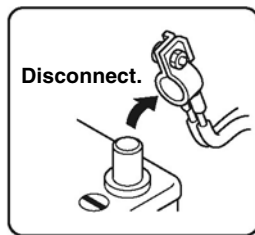
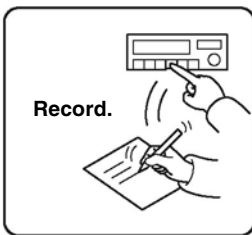
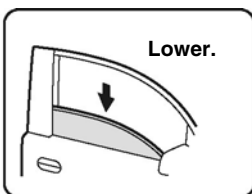

QCD0502BM

## Removing the Vehicle Parts

4. Insert a shop towel to protect the vehicle.
5. Remove the left mirror holder.

### NOTICE

- Be careful not to forcedly remove the mirror holder fixed with clip. The mirror holder or actuator will be damaged.
- Remove in the order shown.

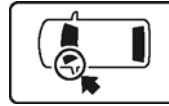

FLAT-TIP  
SCREWDRIVER

SHOP TOWEL

LEFT MIRROR  
HOLDER

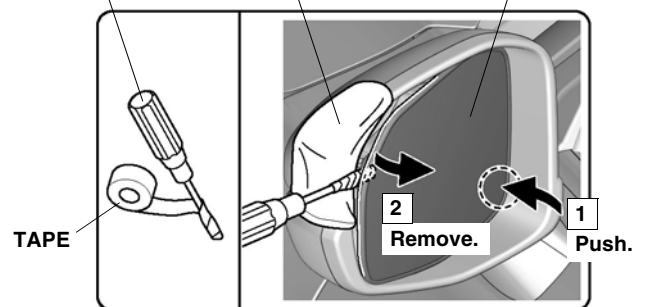

LEFT DOOR MIRROR

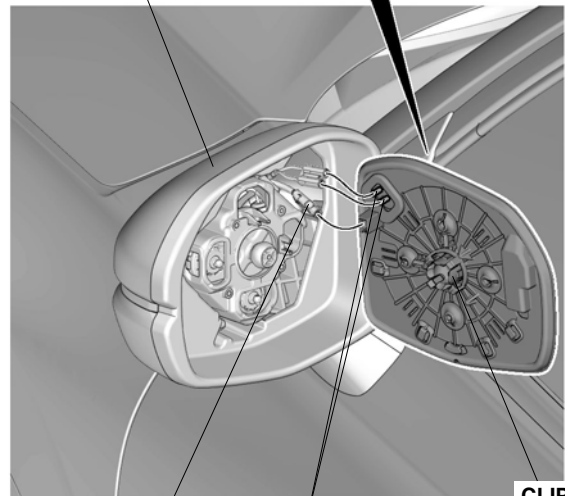

VEHICLE  
CONNECTOR  
(if equipped)

VEHICLE  
TERMINALS  
(if equipped)

CLIP

QL60901AT

6. Attach the tapes to protect the vehicle.

**NOTICE**

- Do not remove the tapes until after the reinstallation.

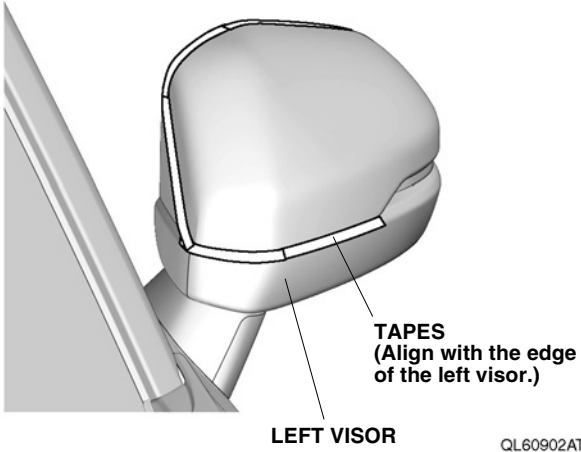

QL60902AT

7. Release the retaining tabs.

**NOTICE**

- Be careful not to damage the retaining tabs.

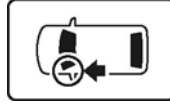

**FLAT-TIP  
SCREWDRIVER**

**2 RETAINING TABS**

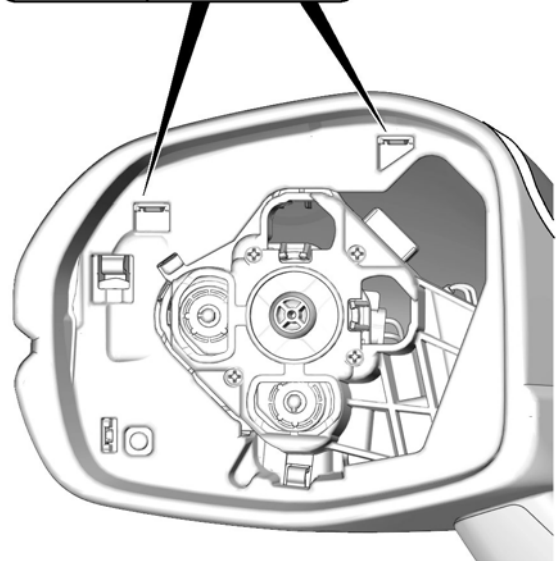
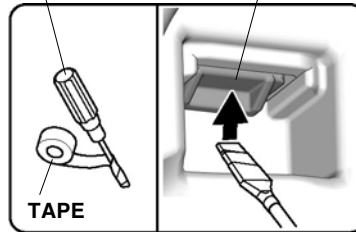

QL60903AT

8. Remove the left scull cap.

**NOTICE**

- Be careful not to damage the retaining tabs.
- Make sure that there is no crack or no deformation on the scull cap.
- Make sure that no broken tab remains.

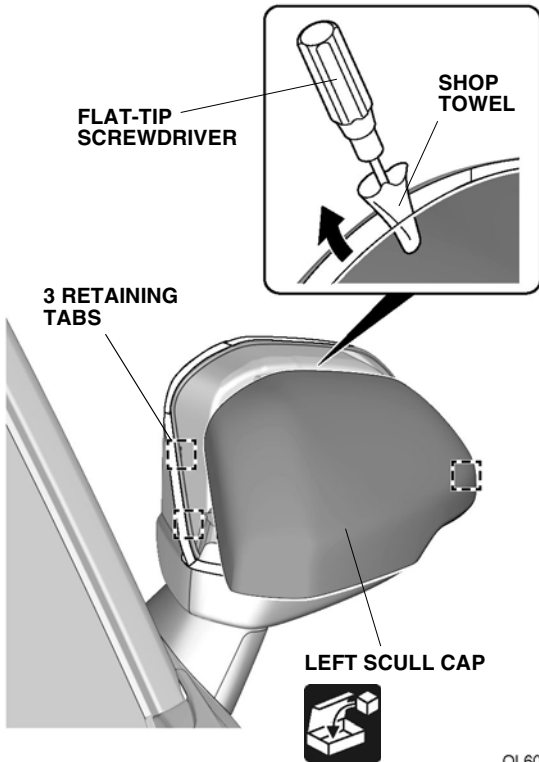
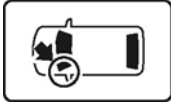

QL60904AT

## Installing the Covers

9. Install the left cover.

**NOTICE**

- Make sure that there is no gap between the cover and the visor.
- Make sure to secure the retaining tabs properly.

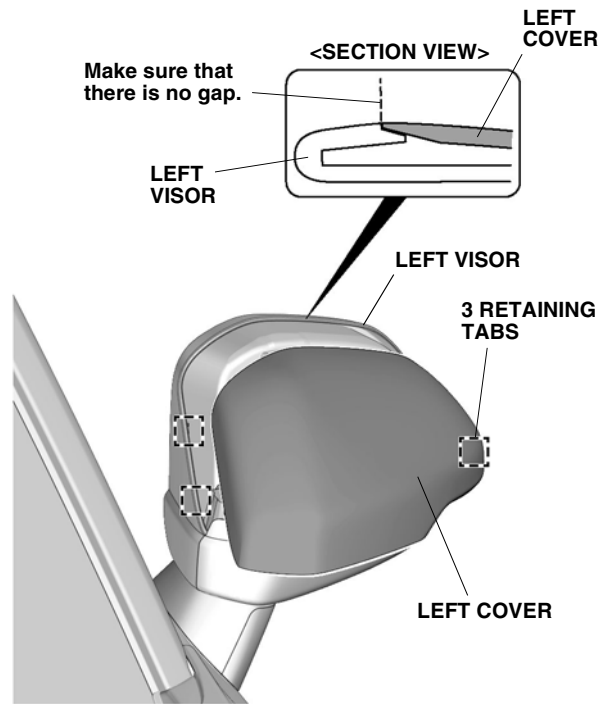
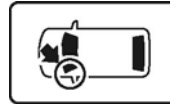

QL60905AT

10. Push the actuator rods and memory rods (if equipped).

### NOTICE

- Make sure to install the actuator rod in the correct orientation.
- Apply the grease as described in the Shop Manual.

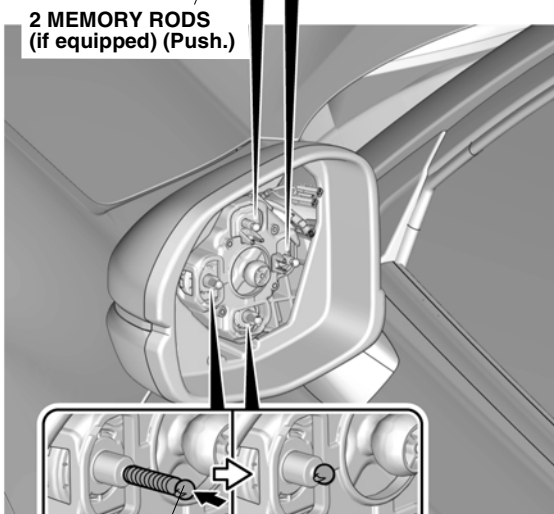
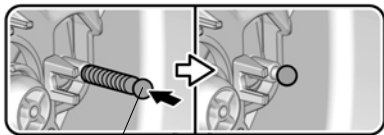
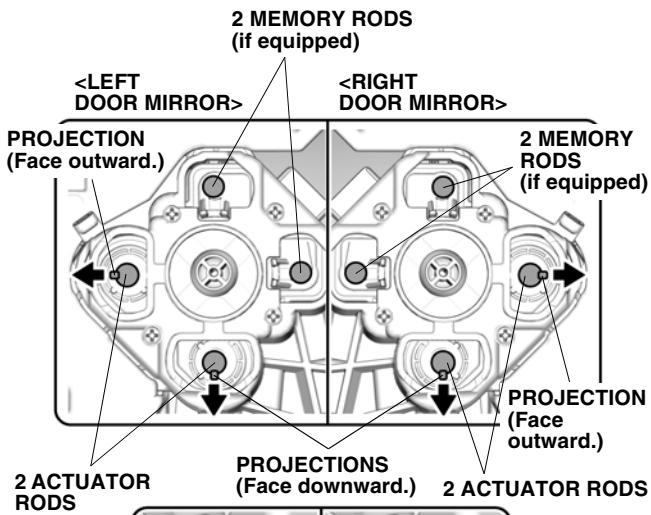

2 ACTUATOR RODS (Push.)

QN30101BU

11. Reinstall the left mirror holder.

### NOTICE

- Make sure to check the actuator rod and the memory rod (if equipped) are installed properly.
- Install in the order shown.

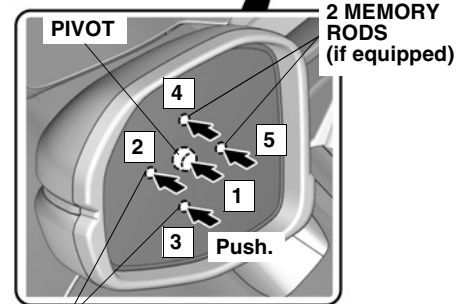
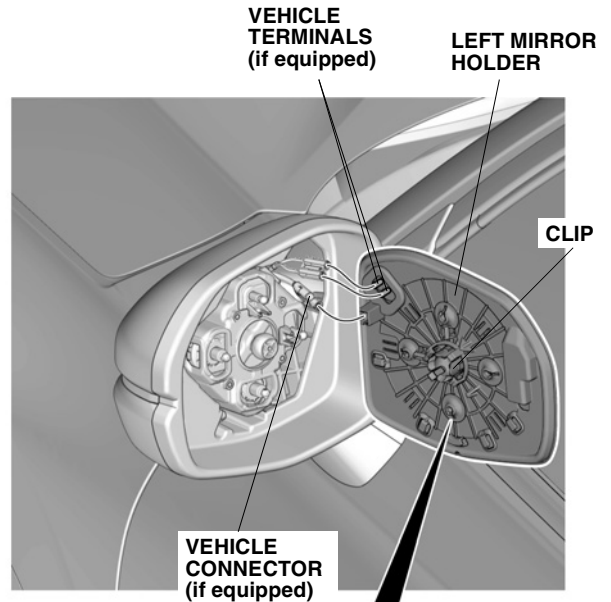

2 ACTUATOR RODS

QN30102AU

12. Check the left mirror holder.

**NOTICE**

- Move the mirror holder in all directions to check if it is installed securely.

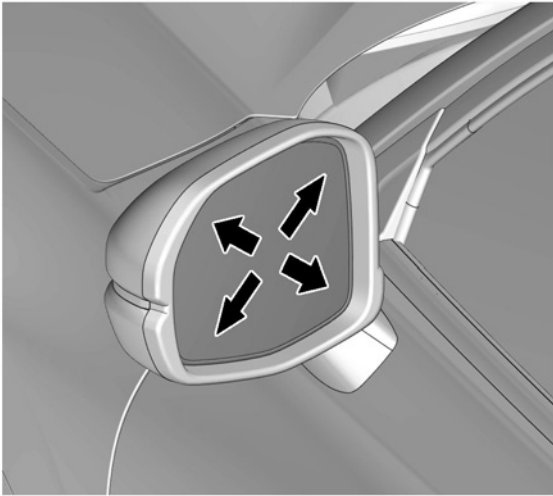

QL60908AT

13. Repeat same procedures for the other side.

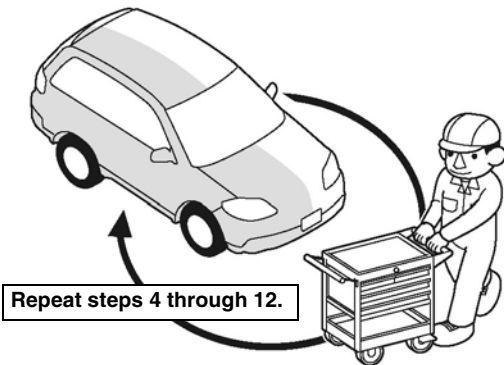

Q9D1014AM

## Check After Installation

14. Check that all parts are routed and installed properly.

**NOTICE**

- Check that the harnesses are not pushed, not pulled and not pinched.
- Check that all clamps and wire ties are installed securely.

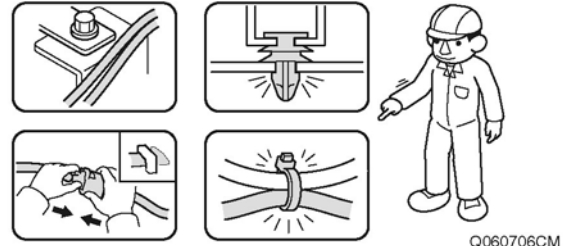

Q060706CM

## Operation Check

15. Reconnect the negative cable to the battery.

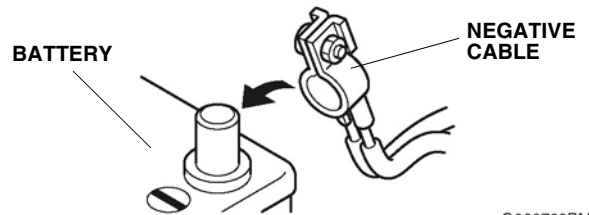

Q060702BM

16. Check that the turn signal, angle adjustment and movement of the mirror operate properly.

## Vehicle Check

17. Check that the electric accessories and systems operate properly.
18. Press and hold the audio power button for two seconds, or enter anti-theft code for the audio/navigation system.
19. Reset the memory of each equipment and restore the positions of those control knobs.

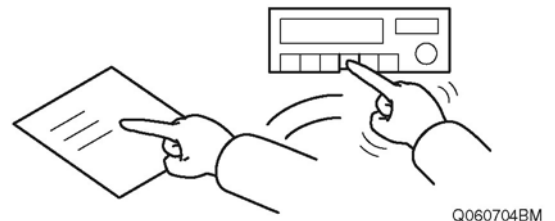

Q060704BM